







































# SPANISH PINES UNIT III SUBDIVISION

BEING ALL OF TRACT 6D AND A  
 PORTION OF TRACT 6A1, BLOCK 9  
 UPPER VALLEY SURVEYS  
 EL PASO COUNTY, TEXAS

## VICINITY MAP

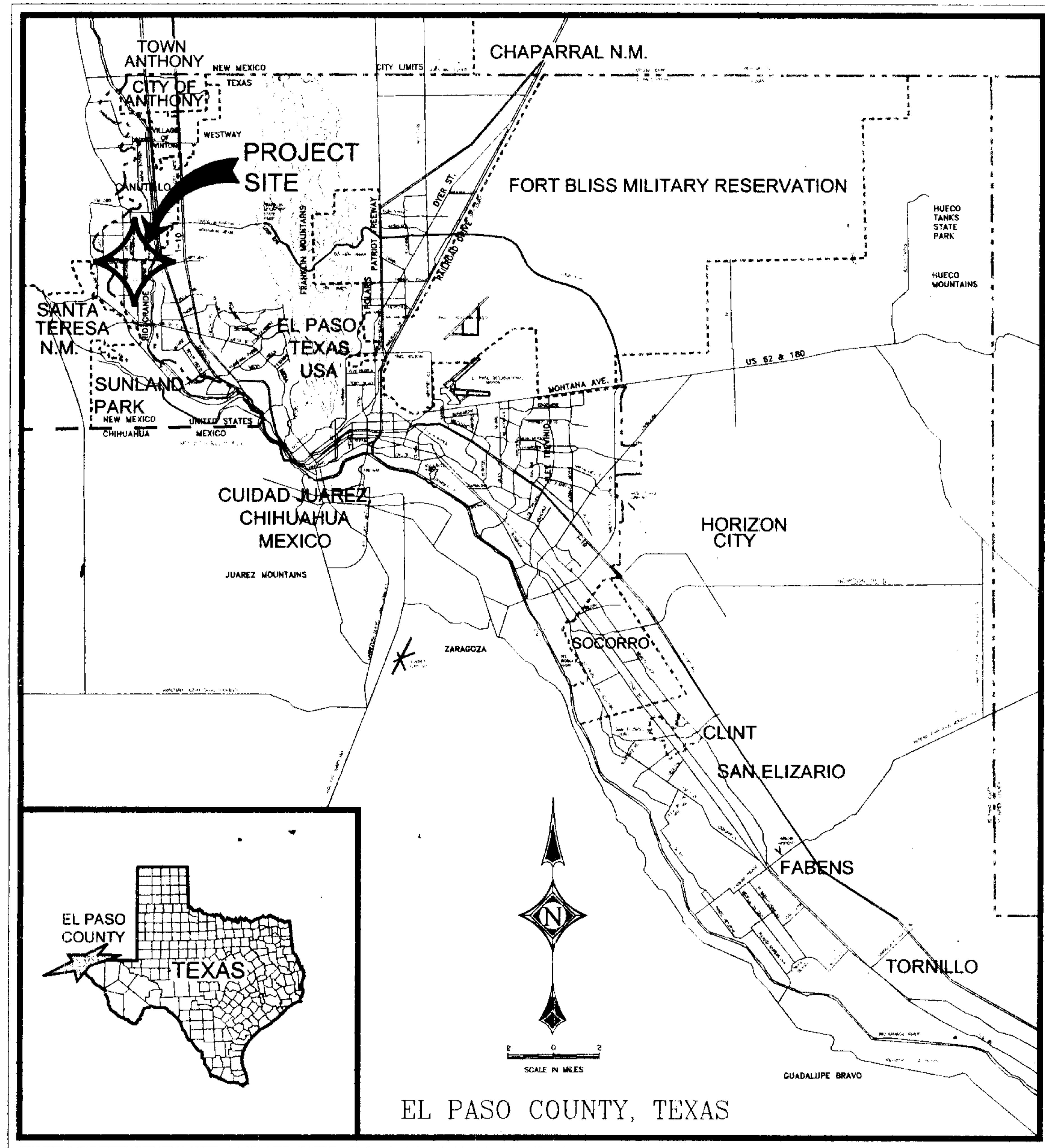

LAND SURVEYOR

## INDEX SHEET

- FINAL PLAT**
- C-01 GRADING & DRAINAGE PLAN 1 OF 3
  - C-02 GRADING & DRAINAGE PLAN 2 OF 3
  - C-03 GRADING & DRAINAGE PLAN 3 OF 3
  - C-04 STORMWATER POLLUTION PREVENTION PLAN
  - C-05 ILLUMINATION PLAN
- PLAN AND PROFILES**
- C-06 DONA BEATRIZ LANE 0+00-7+00 1 OF 2
  - C-07 DONA BEATRIZ LANE 7+00-13+03.87 2 OF 2
  - C-08 DONA BEATRIZ CIRCLE 0+00-6+89.74 1 OF 3
  - C-09 DONA BEATRIZ CIRCLE 6+89.74-12+50.99 2 OF 3
  - C-10 DONA BEATRIZ CIRCLE 12+50.99-19+51.92 3 OF 3
  - C-11 ALCALA COURT 0+00-1+81.98
  - PAMPLONA COURT 0+00-1+82.70
  - CASTILLO COURT 0+00-1+92.23
  - C-12 ALANDALUS DRIVE 3+27.64-4+79.64
  - MURCIA DRIVE 1+47-2+99
  - C-13 ADA LANE 0+00-3+04.12
  - C-14 TYPICAL SECTIONS
  - C-15 STANDARD DETAILS

## LOCATION MAP

SCALE: 1"=600'

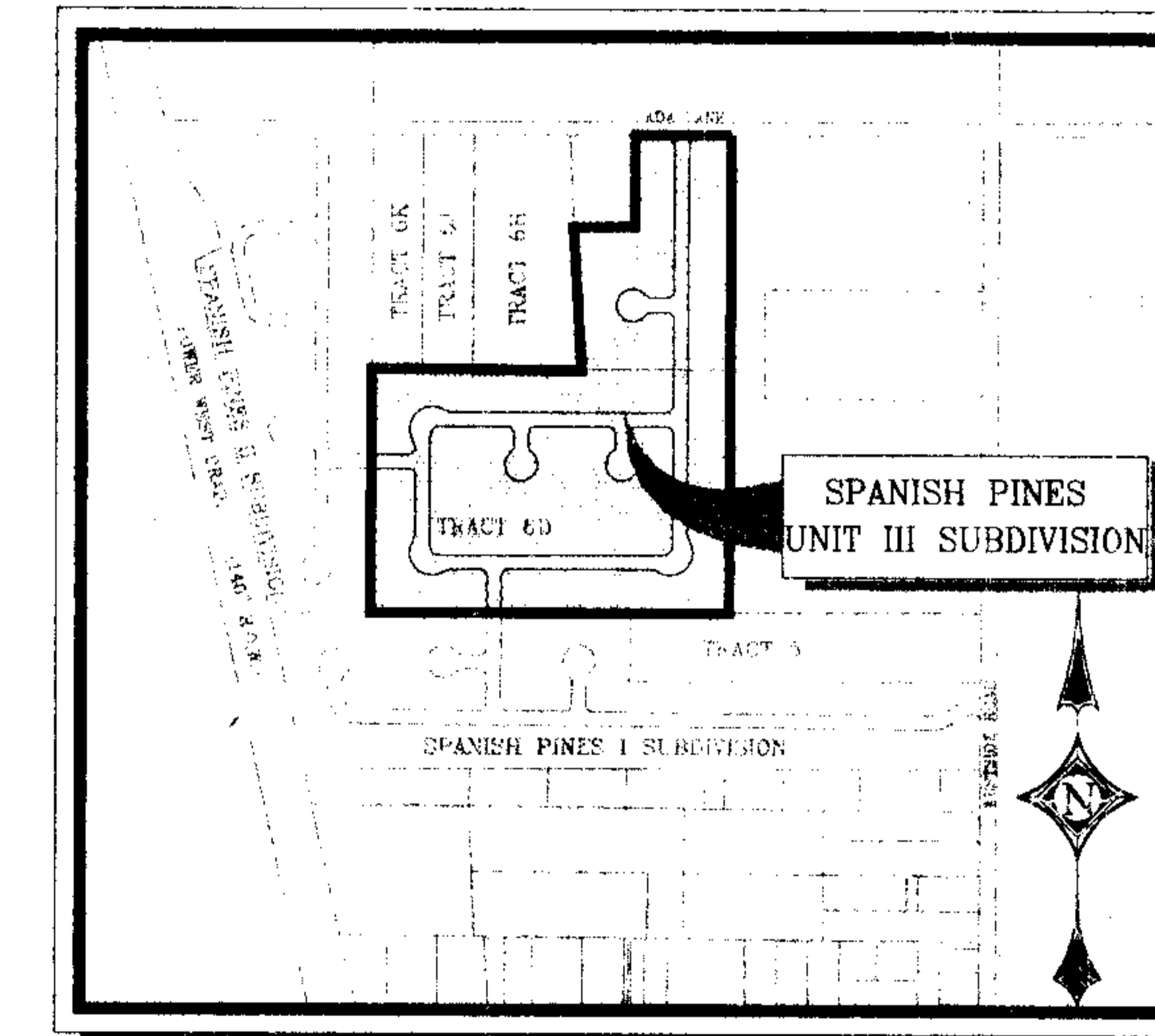

Plans prepared by:  
 CIVIL ENGINEER

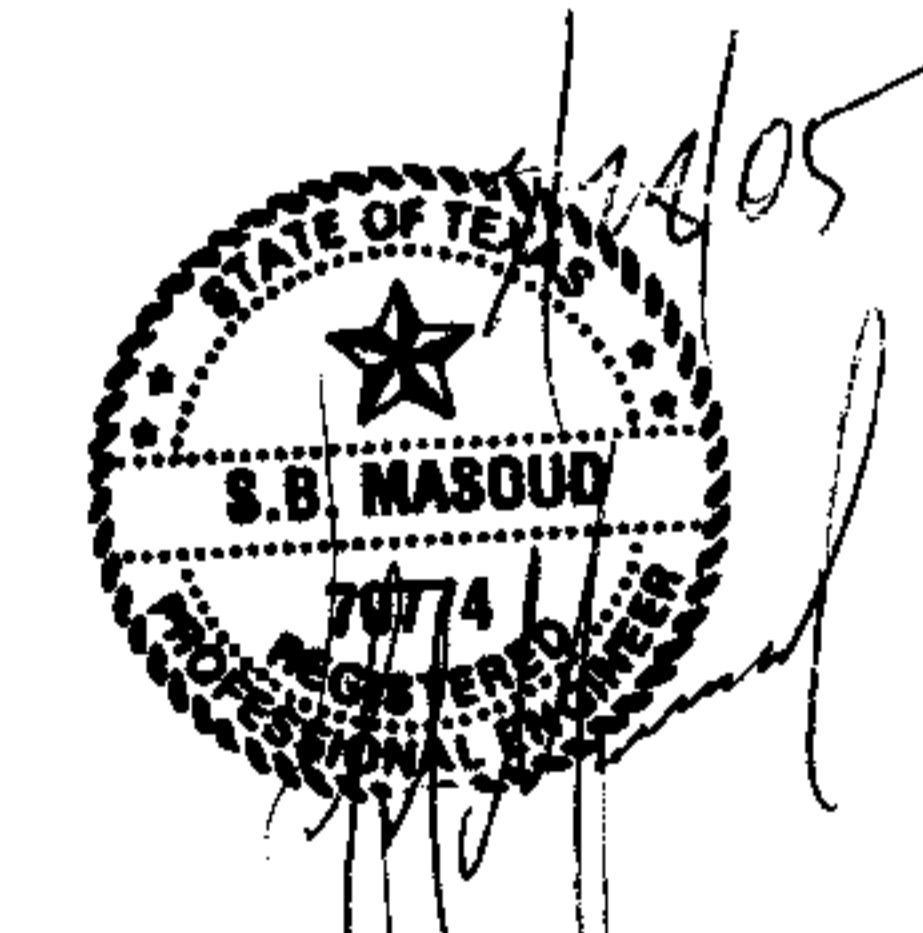

**CONSULTING COMPANY**

1790 N. LEE TREVINO DR. SUITE 503  
 EL PASO, TEXAS 79936  
 TEL (915) 633-6422 FAX (915) 633-6424

**ENGINEERING DEPARTMENT APPROVED**  
 for conditions related to:

- Grading and drainage
- Sidewalks
- Driveways
- Wheelchair ramps
- On-site ponding of storm waters
- Retaining rock wall
- On-site parking layout

The contractor shall call City Engineering at 541-4970 at least 24 hours prior to construction for inspections. Plans must comply with City of El Paso Municipal Code requirements.

By *[Signature]* Date 3-29-05

**DRE** Del Rio Engineering, Inc.  
 P.O. Box 220251 El Paso, Texas 79913 915/833-2400

SPANISH PINES UNIT III SUBDIVISION