

By *[Signature]* Date *6/17/05*
 The contractor shall call City Engineering at 541-4970 at least 24 hours prior to construction for inspections. Plans must comply with City of El Paso Municipal Code requirements.

Grading and drainage
 Sidewalks
 Driveways
 Wheelchair ramps
 On-site parking layout
 Retaining rock wall
 On-site parking layout
 S41-4970 at least 24 hours prior to construction for inspections. Plans must comply with City of El Paso Municipal Code requirements.

TITLE	SHEET No.
COVER SHEET	1 OF 13
PLAT	2 OF 13
GRADING PLAN	3 OF 13
GRADING SECTIONS	4 OF 13
DRAINAGE PLAN	5 OF 13
STORM WATER POLLUTION PREVENTION PLAN	6-7 OF 13
PLAN & PROFILE	8-10 OF 13
STANDARD DETAILS	11-12 OF 13
ILLUMINATION PLAN AND DETAILS	13 OF 13

I N D E X

STREET IMPROVEMENTS

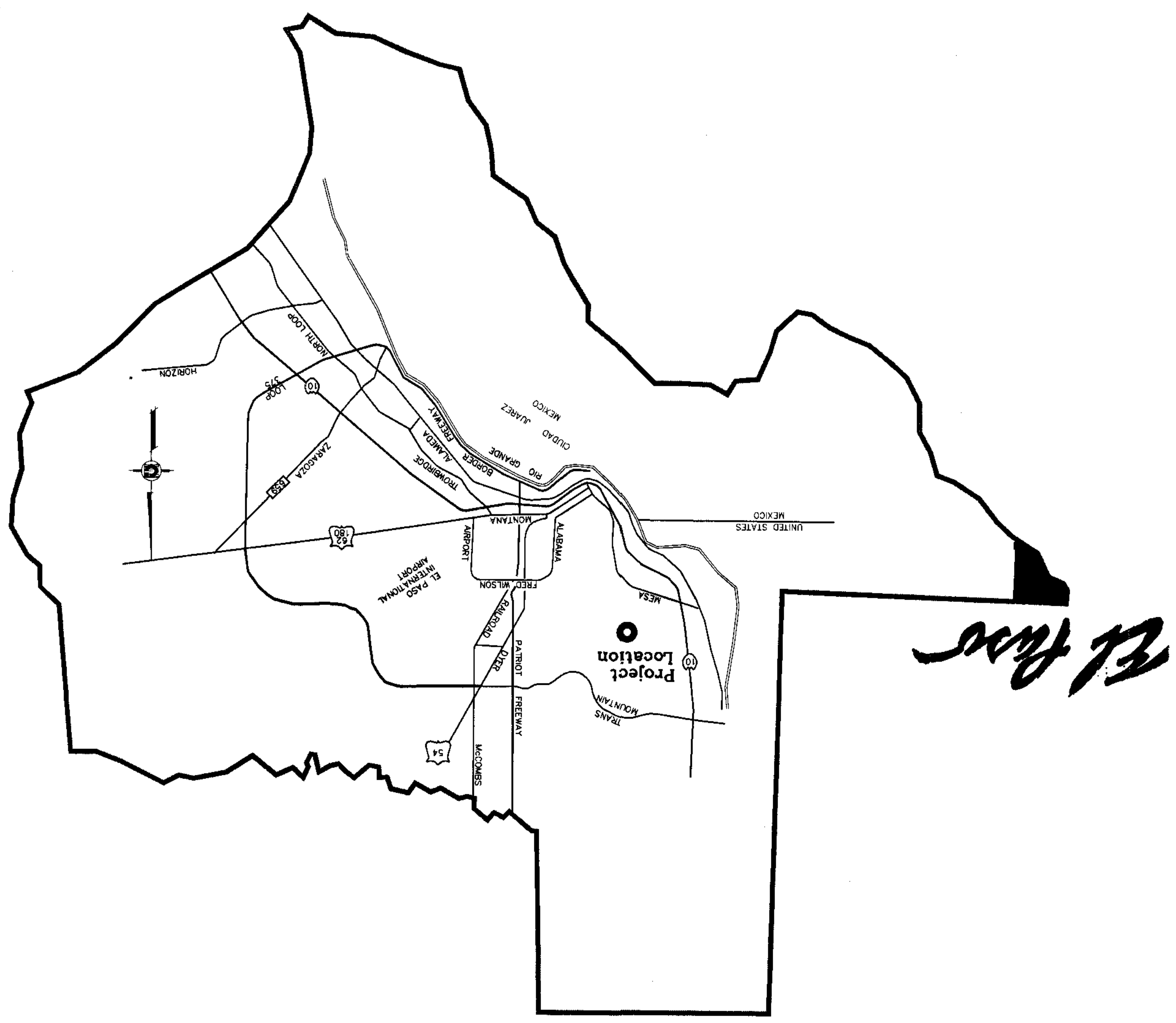
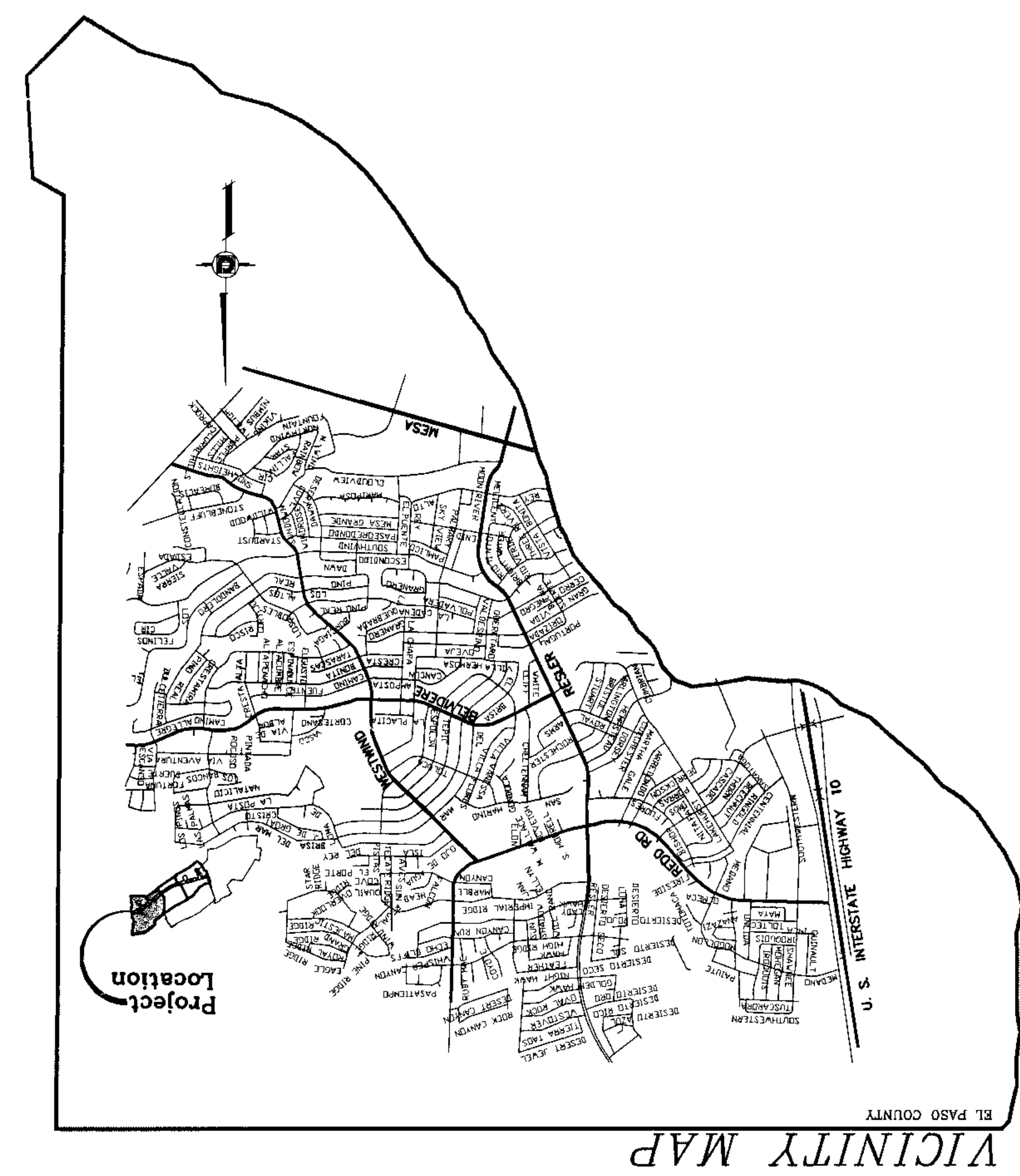
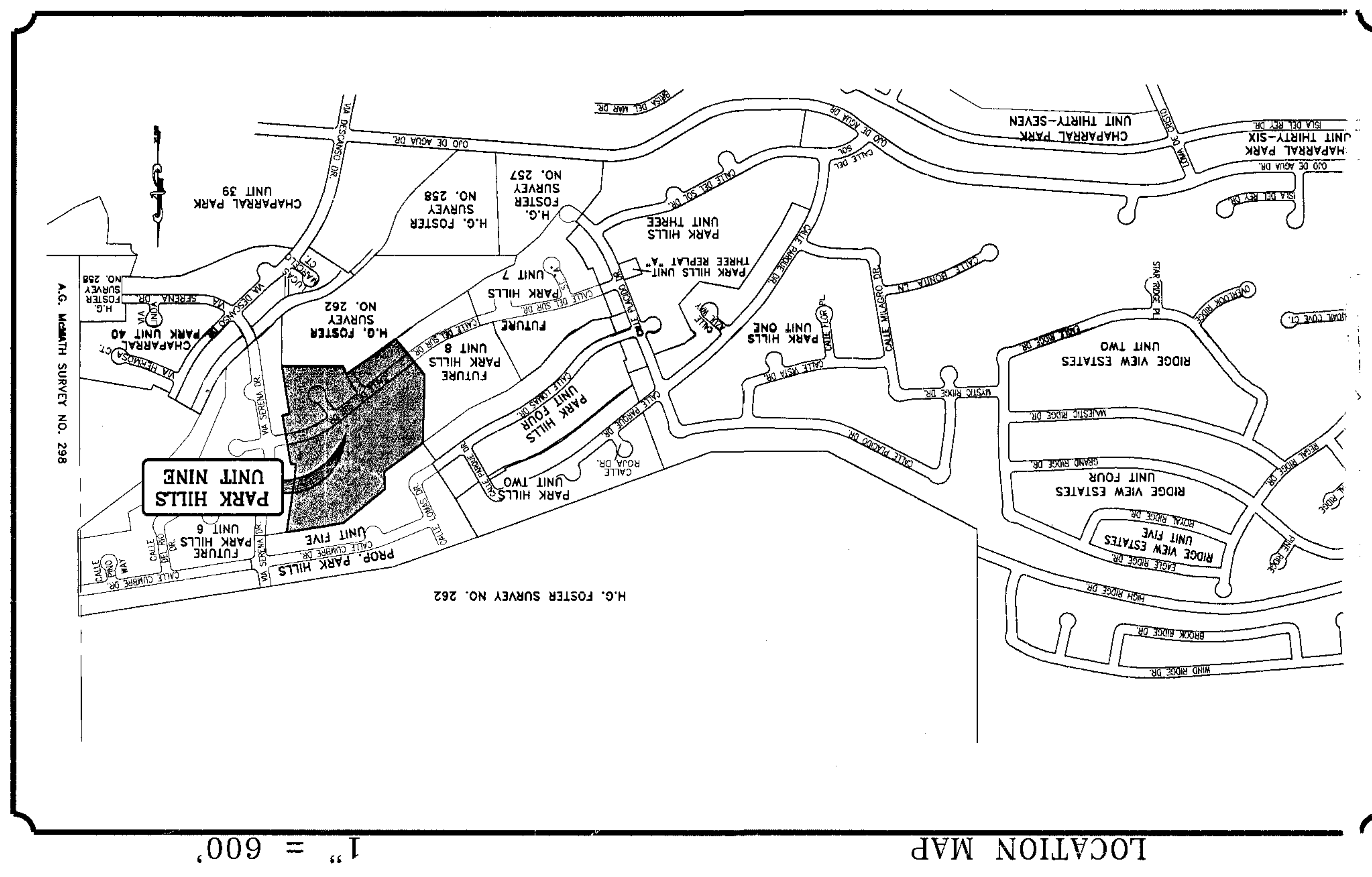

El Paso

GOOD SET
6-21-05

PROJECT NAME
PARK HILLS UNIT NINE

BEING A PORTION OF H.G. FOSTER
 SURVEY NO. 282
 CITY OF EL PASO, EL PASO COUNTY, TEXAS.
 CONTAINING: 14.84 ACRES

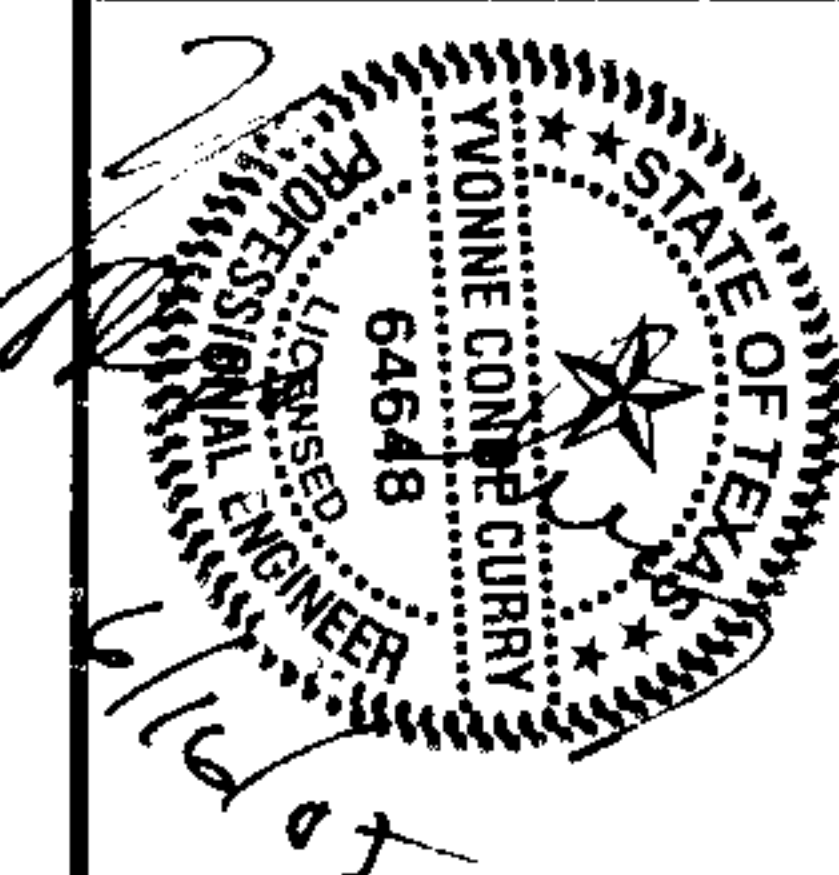

CONDE INC.
 ENGINEERING / PLANNING
 SURVEYING / GPS
 1790 LEE TREVINO DR. STE. 400
 EL PASO, TEXAS 79908

