

LOCATION MAP 1" = 600'

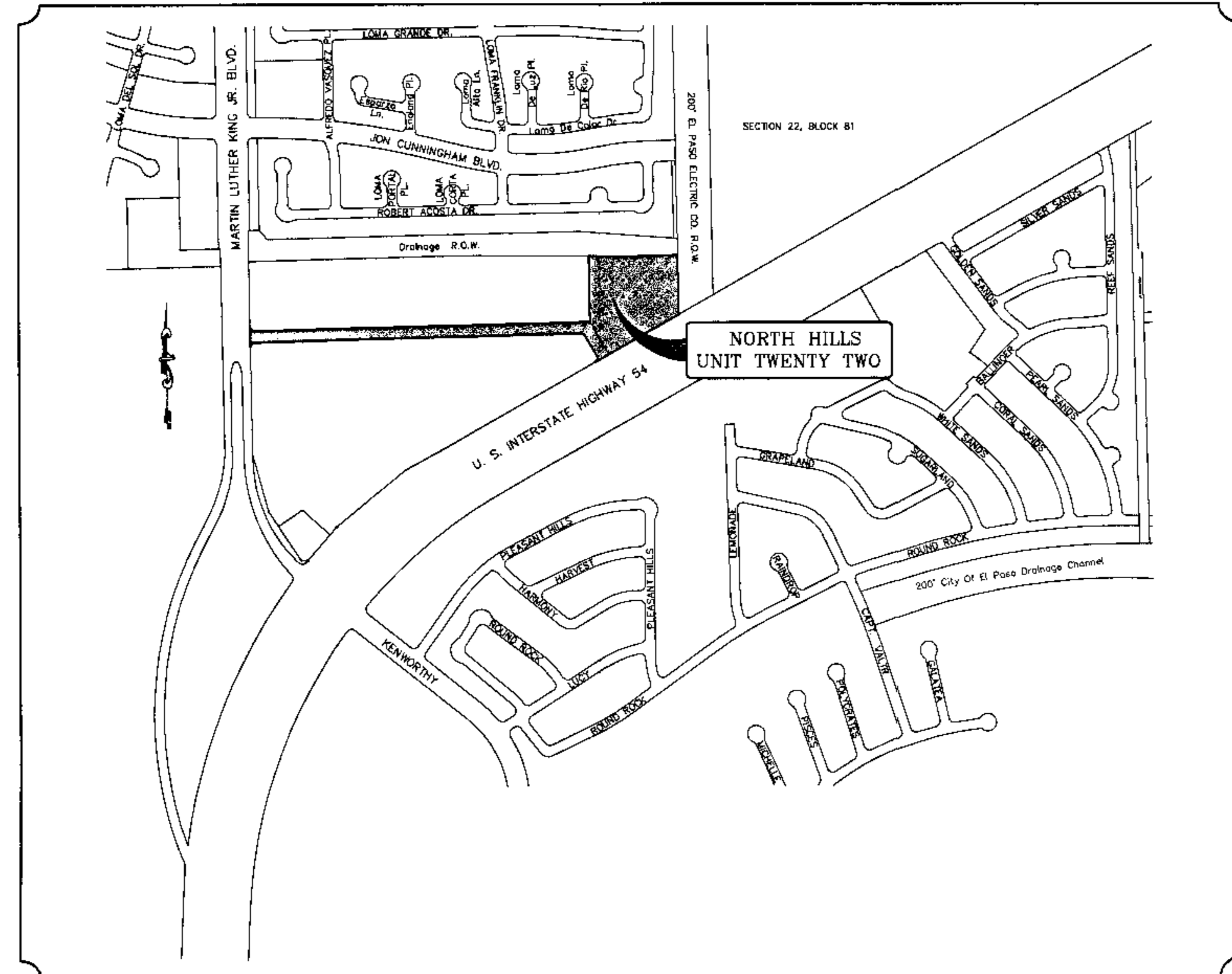

# STREET IMPROVEMENTS

## I N D E X

TITLE	SHEET No.
COVER SHEET	1 OF 17
PLAT	2 OF 17
GRADING PLAN	3 OF 17
GRADING SECTIONS	4 OF 17
DRAINAGE PLAN	5 OF 17
STORM WATER POLLUTION PREVENTION PLAN	6-7 OF 17
PLAN & PROFILE	8-10 OF 17
DECELERATION LANES	10A-10B OF 17
DRAINAGE PROFILES AND STRUCTURES	11-15 OF 17
STANDARD DETAILS	16 OF 17
ILLUMINATION PLAN AND DETAILS	17 OF 17

**DEVELOPMENT SERVICES**  
**PROVIDED**

- Site plan related to:
  - Site plan
  - Site plan drainage
  - Drive ways
  - Wheelchair ramps
  - On-site ponding of storm waters
  - Retaining rock wall
  - On-site parking layout

The contractor shall call Dev. Services, at 541-4070 at least 24 hours prior to construction for inspections. Plans must comply with City of El Paso Municipal Code requirements.

*Handwritten signature and date: [Signature] Date: 9/1/05*

PROJECT NAME  
**NORTH HILLS  
 UNIT TWENTY TWO**  
 BEING A PORTION OF TRACT 1A, SECTION 27, AND PORTION  
 OF SECTION 22, BLOCK 61, TOWNSHIP 1, TEXAS AND  
 PACIFIC RAILROAD COMPANY SURVEYS  
 CITY OF EL PASO, EL PASO COUNTY, TEXAS.  
 Containing: 8.460 ACRES

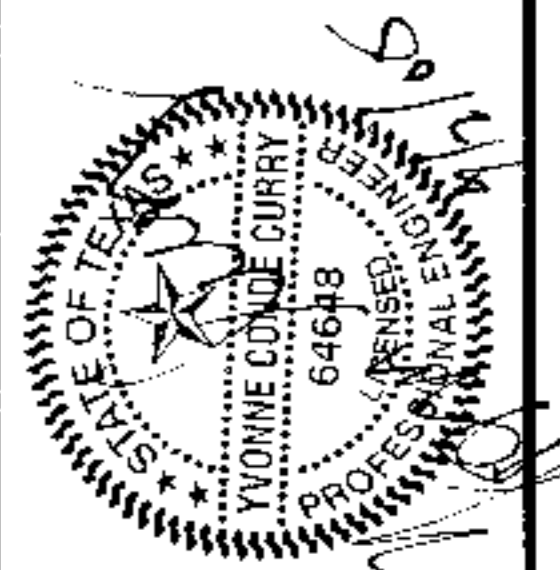

**CONDE INC.**  
 ENGINEERING / PLANNING  
 SURVEYING / GPS  
 1786 LEBLANC ST., SUITE 400  
 EL PASO, TEXAS 79905

