

NEPTUNE SUBDIVISION

BEING A PORTION OF TRACT 181,
SUNRISE ACRES No. 1,
CITY OF EL PASO, EL PASO COUNTY, TEXAS

VICINITY MAP

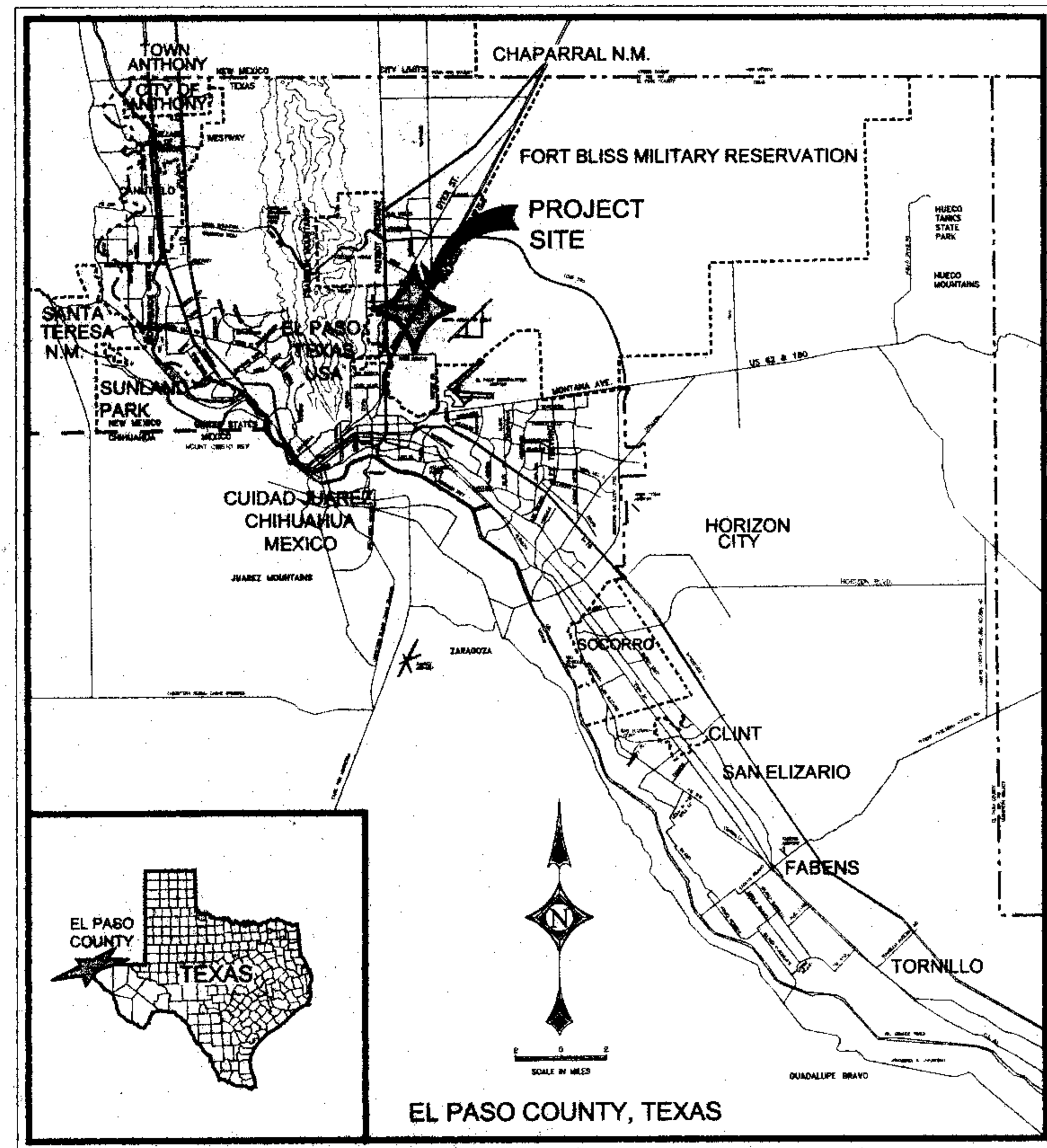

EL PASO COUNTY, TEXAS

LAND SURVEYOR

INDEX SHEET

- FINAL PLAT
- C-01 GRADING PLAN
 - C-02 DRAINAGE PLAN
 - C-03 a STORMWATER POLLUTION PREVENTION PLAN
 - C-03 b STORMWATER POLLUTION DETAILS
 - C-04 STANDARD DETAILS
 - C-05 TYPICAL SECTIONS

DEVELOPMENT SERVICES DEPARTMENT
Reviewing by the City of El Paso shall neither constitute approval nor have responsibility of the adequacy of design and plans.

LOCATION MAP

SCALE: 1" = 300'

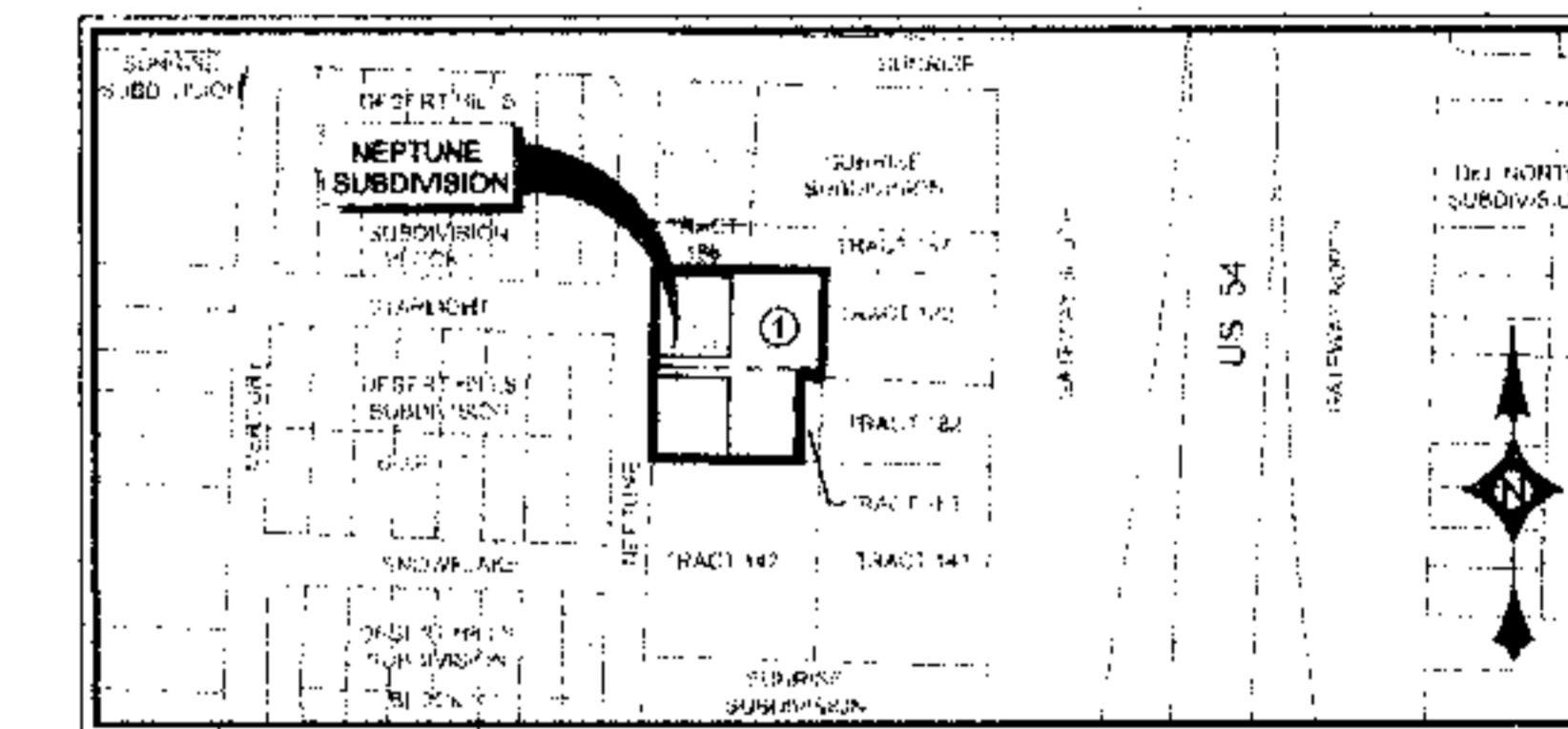

DEVELOPMENT SERVICES DEPARTMENT
SITE PLAN REVIEW
Reviewed For Conformance For Conditions Related To:
Demolition Only
Grading & Drainage
Wheelchair Ramps
On Site Parking Layout
Sidewalks
Driveways
Retaining Rock Walls
On-Site Ponding of Storm Waters
Inspector Must Call 24 Hours Prior To Construction For Inspection
BY: *[Signature]* DATE: 8/8/2006

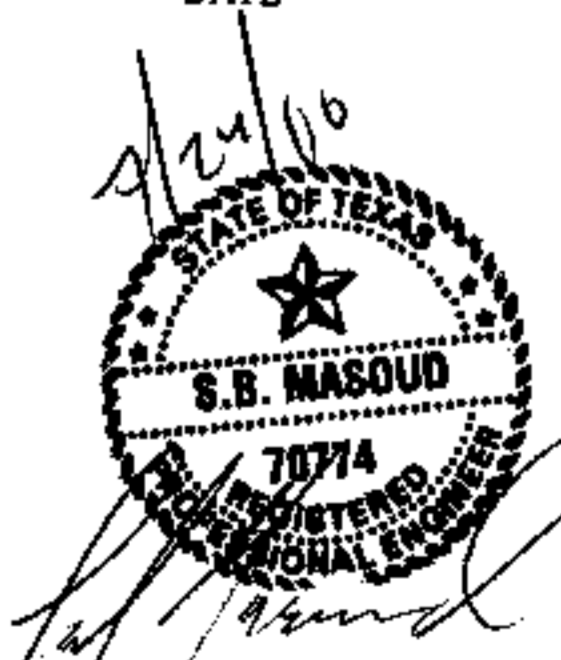

Plans prepared by:
CIVIL ENGINEER



CONSULTING COMPANY

1790 N. LEE TREVINO DR. SUITE 503
EL PASO, TEXAS 79936
TEL (915) 633-6422 FAX (915) 633-6424



Del Rio Engineering, Inc.

P.O. Box 220251 El Paso, Texas 79913 915/833-2400

NEPTUNE SUBDIVISION J05-145