

El Paso

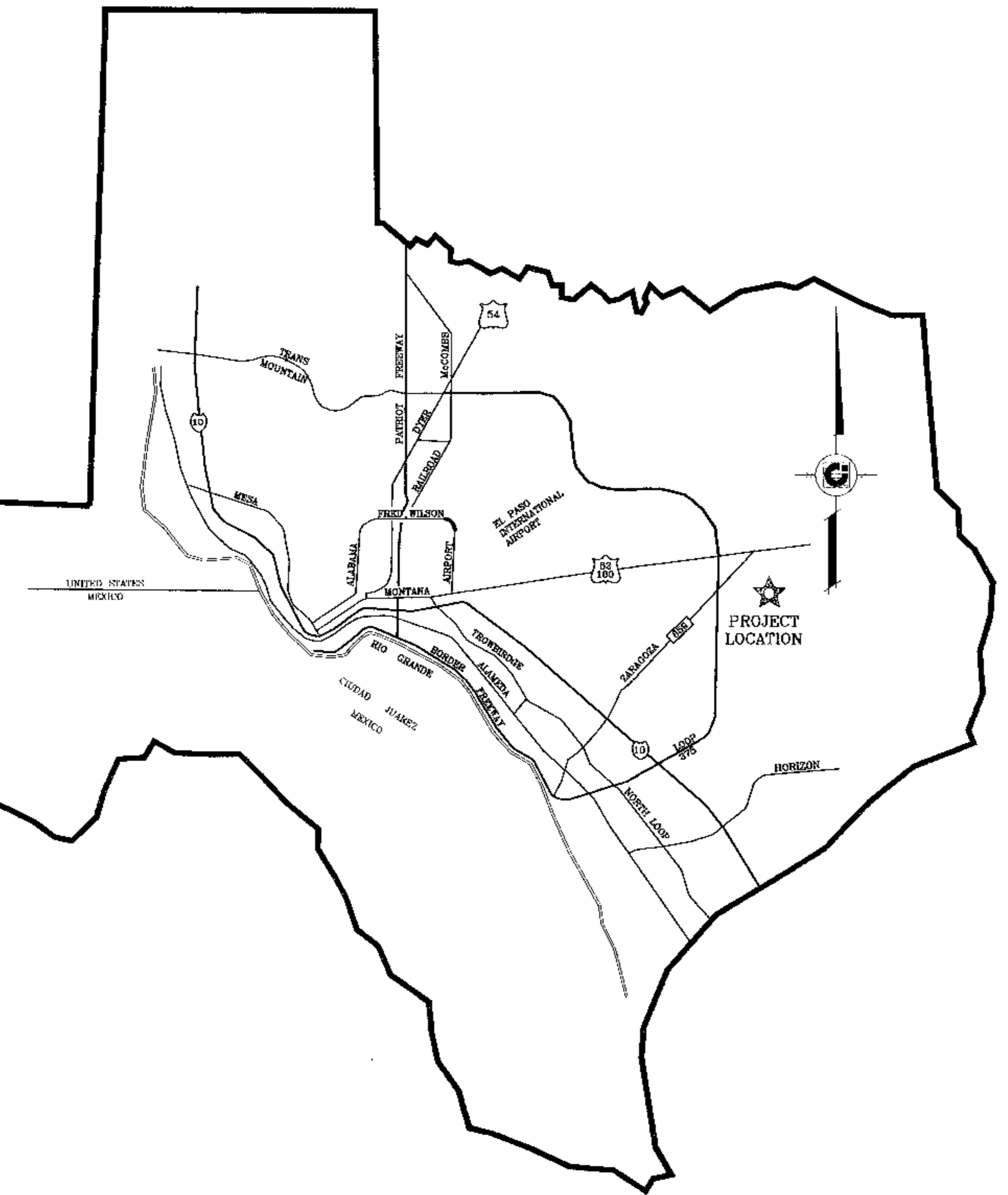

VICINITY MAP

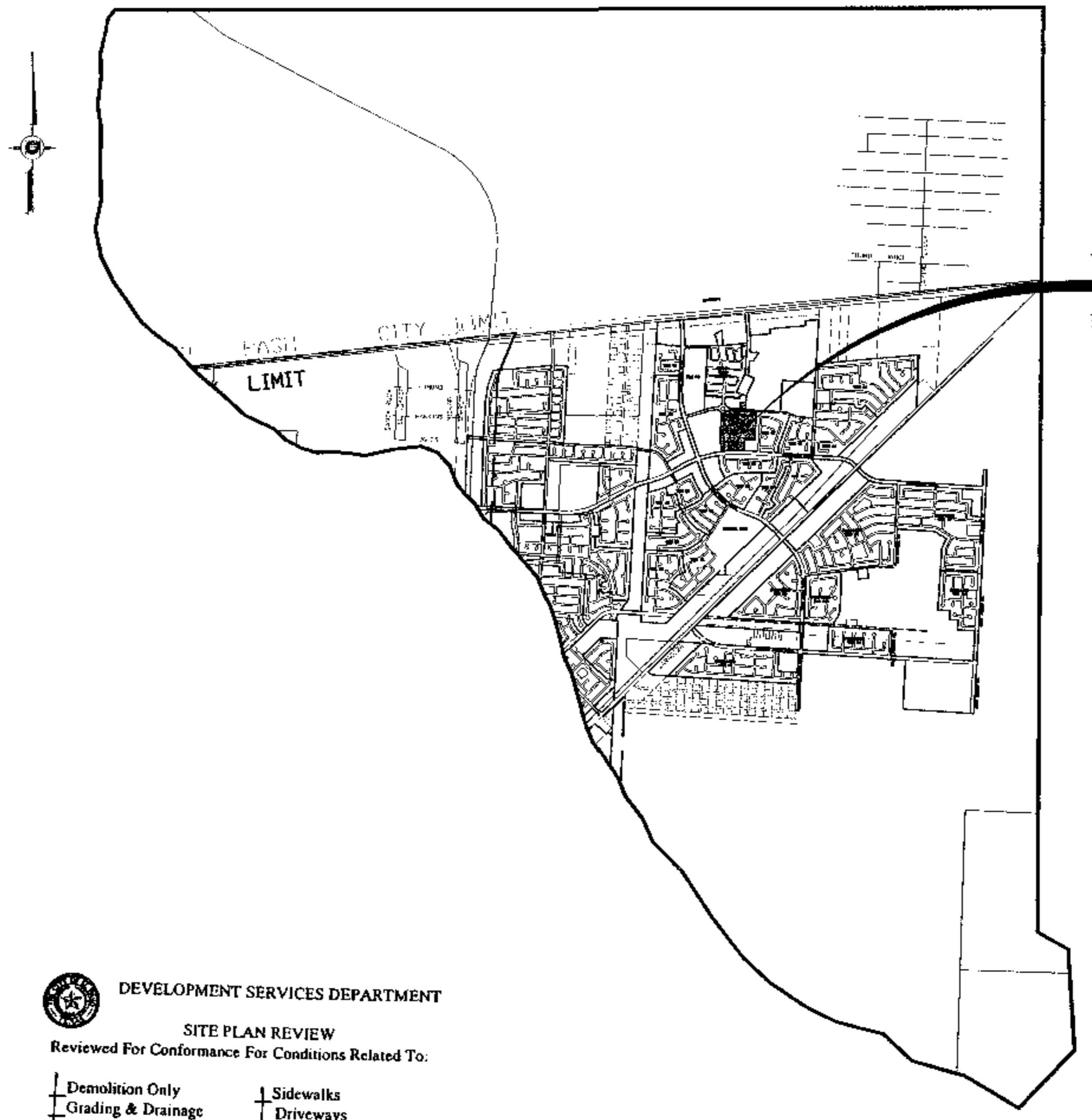

HUECO CLUB
ESTATES UNIT 2
PROJECT
LOCATION

DEVELOPMENT SERVICES DEPARTMENT
SITE PLAN REVIEW
Reviewed For Conformance For Conditions Related To:

- Demolition Only
- Grading & Drainage
- Wheelchair Ramps
- On Site Parking Layout
- Sidewalks
- Driveways
- Retaining Rock Walls
- On-Site Ponding of Storm Waters

Contractor Must Call 48 Hours Prior To Construction For Inspection
 BY *David J. Johnson* DATE *3/21/08*

LOCATION MAP SCALE: 1"=1000'

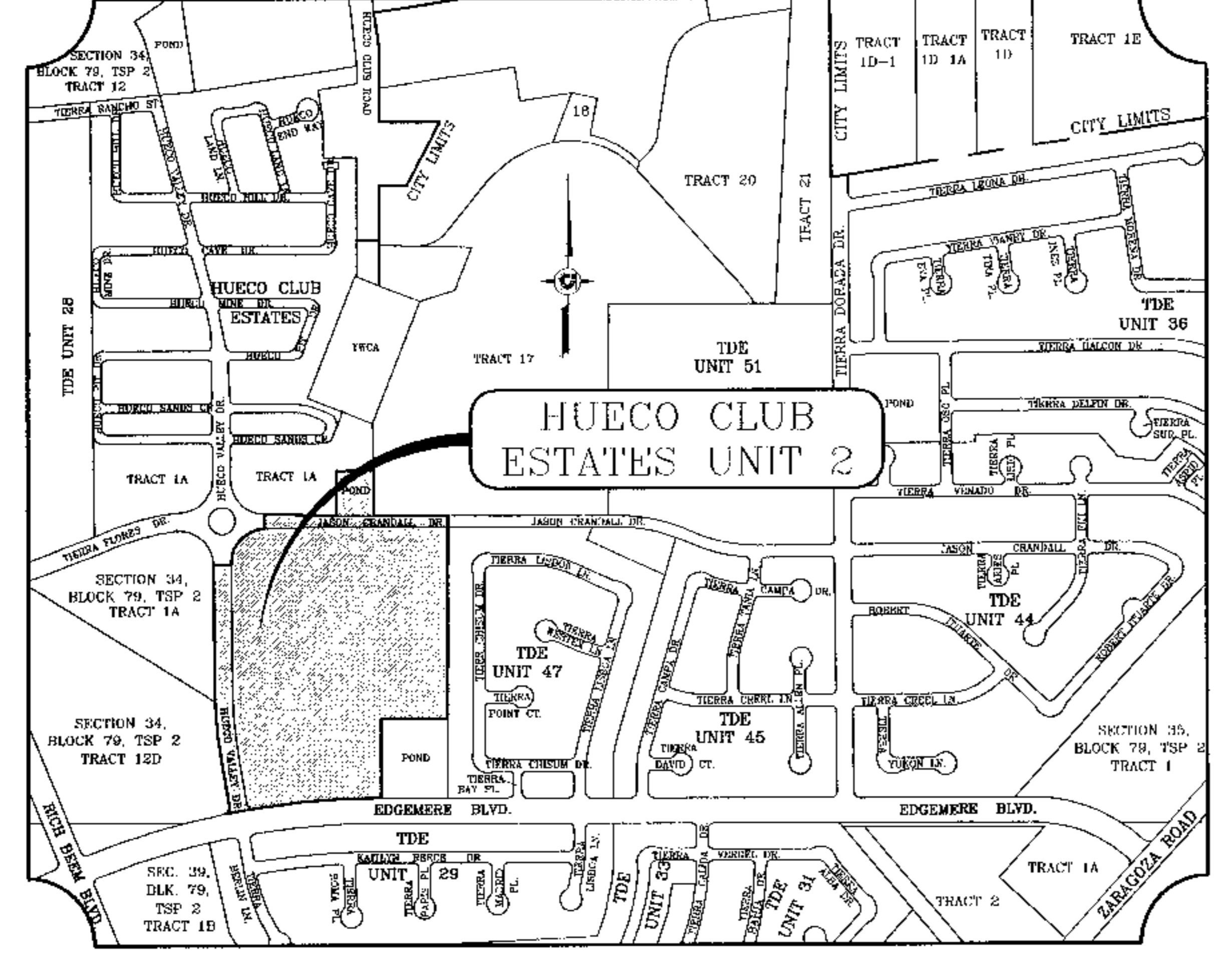

STREET IMPROVEMENTS

I N D E X

TITLE	SHEET No.
COVER SHEET	1 OF 18
PLAT	2 OF 18
GRADING	3 OF 18
DRAINAGE	4 OF 18
S.W.P.P. AND STANDARD DETAILS	5-6 OF 18
HUECO VALLEY DR.	7-8 OF 18
JASON CRANDALL DR.	9-10 OF 18
DRAINAGE STRUCTURES	11-12 OF 18
POND SECTIONS	13-14 OF 18
STRUCTURE DETAILS	15 OF 18
STANDARD DETAILS	16-17 OF 18
TRAFFIC CONTROL PLAN	18 OF 18
LANDSCAPE & IRRIGATION PLAN	1-3 OF 3

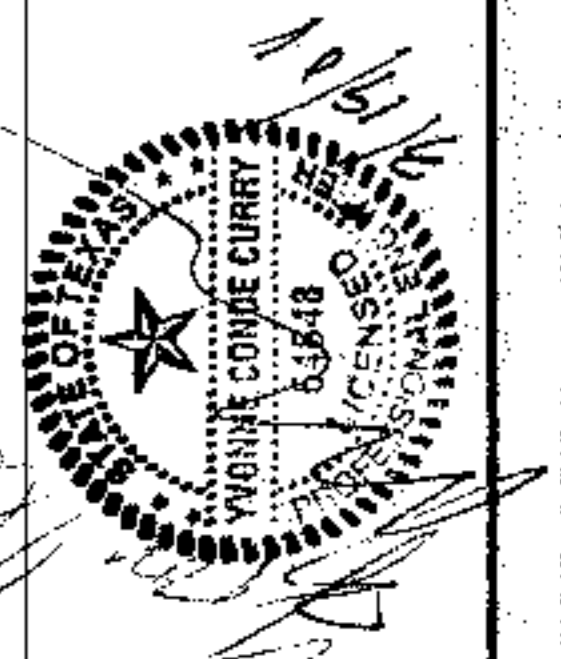

CONDE INC.
ENGINEERING / PLANNING
SURVEYING / GPS
1790 LEE TREVINO STE. 400
EL PASO, TEXAS 79966



C:\Land Projects\2006\HUECO CLUB ESTATES 2\dwg\COVER_SHT.dwg COVER, 3/19/2008 9:52:08 AM